

single, with rapid-change coupling, DIN 808

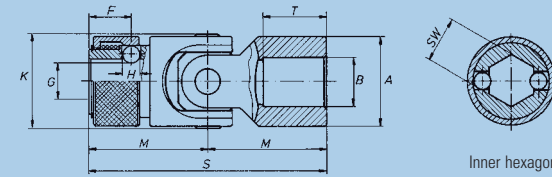
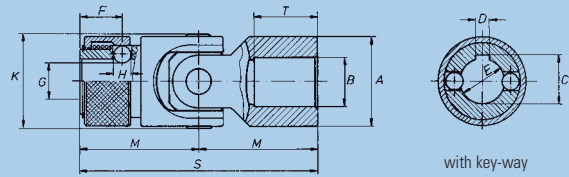

Cross Joints, with rapid-change coupling, Bore with key-way

Order number		0.716.423	0.720.423	0.725.423	0.732.423	0.740.423	0.750.423	0.763.423
Md <sub>max</sub>	Nm	8	20	30	60	160	290	450
Angle of deflection β	°	45	45	45	45	45	45	45
Weight	kg	0,05	0,10	0,16	0,31	0,61	1,15	2,08
A	mm	16	20	25	32	40	50	63
*B <sup>H7</sup>	mm	8	10	14	16	20	25	30
*C <sup>+0,2</sup>	mm	9	11	15,3	17,3	21,7	26,7	31,7
*D <sup>H8</sup>	mm	2	3	5	5	6	8	8
*E <sup>H7</sup>	mm	8	10	14	16	20	25	30
F	mm	9,5	11,5	13,5	14	19	20,5	25
G	mm	7	8,7	13	14,8	18	23	28
H	mm	3,5	4	4	6,35	8	10	10
K	mm	17,5	21,5	26,5	33,5	42	52,5	65
M	mm	26	31	37	43	54	66	83
S	mm	52	62	74	86	108	132	166
*SW <sup>H7</sup>	mm	–	–	–	–	–	–	–
T	mm	15	18	22	25	32	40	50

Cross Joints, with rapid-change coupling, Inner hexagon

	0.716.426	0.720.426	0.725.426	0.725.427	0.732.426	0.740.426	0.750.426	0.763.426	0.763.427
Md <sub>max</sub>	8	20	30	30	60	160	290	450	450
Angle of deflection β	45	45	45	45	45	45	45	45	45
Weight	0,05	0,10	0,16	0,16	0,31	0,61	1,15	2,08	2,08
A	16	20	25	25	32	40	50	63	63
*B <sup>H7</sup>	–	–	–	–	–	–	–	–	–
*C <sup>+0,2</sup>	–	–	–	–	–	–	–	–	–
*D <sup>H8</sup>	–	–	–	–	–	–	–	–	–
*E <sup>H7</sup>	–	–	–	–	–	–	–	–	–
F	9,5	11,5	13,5	13,5	14	19	20,5	25	25
G	6,3	8	13	10,5	14,8	18	23	28	33
H	3,5	4	4	4	6,35	8	10	10	10
K	17,5	21,5	26,5	26,5	33,5	42	52,5	65	65
M	26	31	37	37	43	54	66	83	83
S	52	62	74	74	86	108	132	166	166
*SW <sup>H7</sup>	7,2	9,06	14,04	11,15	16	20	25	30	35
T	15	18	22	22	25	32	40	50	50

\* = Customized bores, key-ways and inner hexagon dimensions possible  
 Md<sub>max</sub> = Max. permissible torque (when using material 1.4057 divide the Md<sub>max</sub>-value in halves)  
 β = Max. angle of deflection per joint  
 For application criteria and calculations refer to technical annex

■ TIP ■

There are application examples in which frequent removal of the universal joint shaft or the joint from the drive or the output shaft is required.

In this case the use of a rapid-change coupling allows to change the shaft within very short time. This is done manually without any tools.

Torque transmission is ensured via a hexagonal profile or a feather key. Two steel balls which grip into a circular groove at the shaft connection provide axial locking of the shaft.



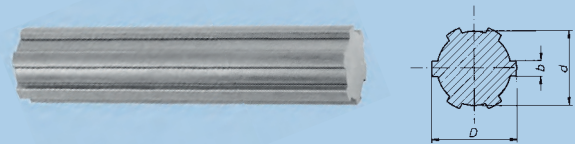

Spline Shafts DIN ISO 14

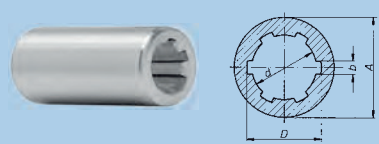

Spline Bore Hubs DIN ISO 14

Material: C40 k, 1.0511 oder C45 k, 1.0503  
Material: 35 S 20 k, 1.0726

Material: 11SMnPb 30 k, 1.0718

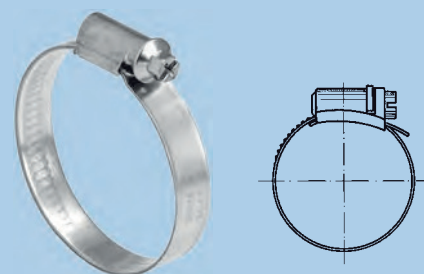

Material: steel, zinc-plated or stainless steel, corrosion- and acid-resistant



Material: neoprene; temperature-resistant up to 100 °C

Also available with Spigots

Spline Shafts DIN ISO 14

Order number	1.000.524.001	1.000.524.002	1.000.524.003	1.000.524.004	1.000.524.005	1.000.524.007	1.000.524.006
Designation	B 6 x 11 x 14	B 6 x 16 x 20	B 6 x 18 x 22	B 6 x 21 x 25	B 6 x 28 x 32	B 6 x 28 x 34	B 6 x 36 x 42
D	mm 14	mm 20	mm 22	mm 25	mm 32	mm 34	mm 42
d	mm 11	mm 16	mm 18	mm 21	mm 28	mm 28	mm 36
b	mm 3	mm 4	mm 5	mm 5	mm 7	mm 7	mm 8
Available in all lengths up to	mm 3000	mm 3000	mm 3000	mm 3000	mm 500*	mm 3000	mm 500*

Material: C40 k, 1.0511 oder C45 k, 1.0503  
\* = Material: 35 S 20 k, 1.0726

Spline Bore Hubs DIN ISO 14

Order number	1.000.511.001	1.000.511.002	1.000.511.003	1.000.511.004	1.000.511.005	1.000.511.007	1.000.511.006
Designation	A 6 x 11 x 14	A 6 x 16 x 20	A 6 x 18 x 22	A 6 x 21 x 25	A 6 x 28 x 32	A 6 x 28 x 34	A 6 x 36 x 42
D	mm 14	mm 20	mm 22	mm 25	mm 32	mm 34	mm 42
d	mm 11	mm 16	mm 18	mm 21	mm 28	mm 28	mm 36
b	mm 3	mm 4	mm 5	mm 5	mm 7	mm 7	mm 8
A	mm 20	mm 28	mm 36	mm 40	mm 50	mm 50	mm 60
Length*	mm 50	mm 60	mm 70	mm 70	mm 80	mm 60	mm 100

\* = max. grip length even  
Material: 11SMnPb 30 k, 1.0718

Hose Clips, steel, zinc-plated

Order number	1.000.961.011	1.000.961.029	1.000.961.003	1.000.961.006	1.000.961.012	1.000.961.013	1.000.961.014	1.000.961.010
Joint-size	0.716/0.816/ 0.720/0.820	0.824/0.725/ 0.828	0.732/0.832/ 0.836	0.740/0.840/ 0.845	0.750/0.850/ 0.855	0.860/0.865	0.870	0.880
Clamping range	mm 12 – 20	mm 20 – 32	mm 25 – 40	mm 32 – 50	mm 40 – 60	mm 50 – 70	mm 60 – 80	mm 70 – 90

Hose Clips, stainless steel, corrosion- and acid-resistant

Order number	1.000.961.020	1.000.961.022	1.000.961.023	1.000.961.024	1.000.961.025	1.000.961.026	1.000.961.027	1.000.961.028
Joint-size	0.716/0.816/ 0.720/0.820	0.824/0.725/ 0.828	0.732/0.832/ 0.836	0.740/0.840/ 0.845	0.750/0.850/ 0.855	0.860/0.865	0.870	0.880
Clamping range	mm 12 – 20	mm 20 – 32	mm 25 – 40	mm 32 – 50	mm 40 – 60	mm 50 – 70	mm 60 – 80	mm 70 – 90

Bellows

Order number	1.000.830.009	1.000.830.010	1.000.830.013	1.000.830.014	1.000.830.002	1.000.830.003
Joint-size	0.716/0.816	0.720/0.820	0.725/0.824	0.828	0.732/0.832	0.836
L	mm 40	mm 47	mm 52	mm 58	mm 67	mm 74
D	mm 31	mm 33	mm 46	mm 50	mm 54	mm 65
d	mm 16	mm 20	mm 25	mm 28	mm 32	mm 36

1.000.830.004	1.000.830.015	1.000.830.016	1.000.830.006	1.000.830.007	1.000.830.017
0.740/0.840	0.845	0.750/0.850	0.855/0.860	0.865/0.870	0.880
84	97	110	122	132	157
75	82	90	100	110	131
040	45	50	56	65	80