

with length compensation, Standard bore

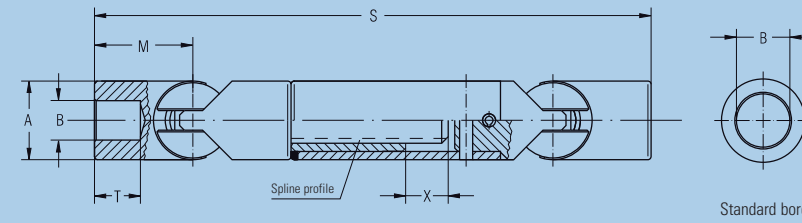
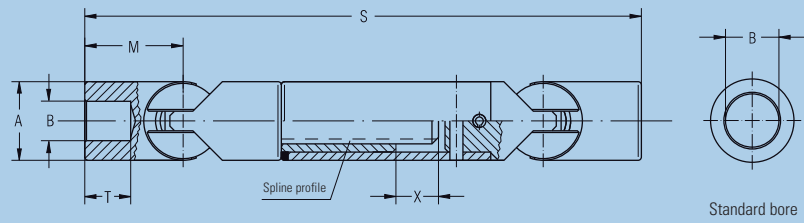

When ordering, please indicate compressed length and extension!

Ball and Socket Shafts, Standard bore

Order number	0.820.100	0.824.100	0.828.100	0.832.100	0.836.100	0.840.100	0.845.100
Md _{max} Nm	20	30	50	60	120	160	200
Angle of deflection β °	35	35	35	35	35	35	35
Weight by S ₁ kg	0,32	0,50	0,78	1,10	1,58	2,17	2,92
Weight by S ₂ kg	0,36	0,58	0,85	1,22	1,72	2,28	3,38
Weight by S ₃ kg	0,40	0,62	0,98	1,33	1,82	2,52	3,68
A mm	20	24	28	32	36	40	45
*B ^{H7} mm	10	12	14	16	18	20	22
*C ^{+0.2} mm	–	–	–	–	–	–	–
*D ^{F9} mm	–	–	–	–	–	–	–
*F ^{H9} mm	–	–	–	–	–	–	–
M mm	25	30	35	40	45	50	55
S ₁ + X ₁ mm	150 + 20	170 + 25	200 + 30	220 + 30	250 + 35	280 + 40	300 + 40
S ₂ + X ₂ mm	170 + 40	200 + 55	220 + 50	250 + 60	280 + 65	300 + 60	350 + 90
S ₃ + X ₃ mm	200 + 70	220 + 75	250 + 80	280 + 90	300 + 85	350 + 110	400 + 140
T mm	13	14	17	19	22	24	26
Spline profile	6x11x14	6x11x14	6x16x20	6x16x20	6x18x22	6x21x25	6x21x25

0.850.100	0.855.100	0.860.100	0.865.100	0.870.100	0.880.100	0.890.100	0.896.100
290	440	520	700	820	930	1060	1250
35	35	35	35	35	35	35	35
4,27	5,50	7,78	10,4	13,6	20,1	27,7	35,8
4,58	5,98	8,45	10,8	14,7	21,9	30,6	38,7
5,18	6,62	9,58	11,8	16,2	24,5	33,5	41,7
50	55	60	65	70	80	90	100
25	30	35	40	45	50	60	70
–	–	–	–	–	–	–	–
–	–	–	–	–	–	–	–
–	–	–	–	–	–	–	–
62,5	67,5	82,5	95	105	115	130	145
350 + 50	400 + 50	450 + 50	520 + 70	580 + 70	630 + 70	700 + 70	800 + 100
400 + 100	450 + 100	500 + 100	550 + 100	630 + 120	700 + 140	800 + 170	900 + 200
450 + 150	500 + 160	580 + 180	630 + 180	700 + 190	800 + 240	900 + 270	1000 + 300
30	35	42	46	52	58	70	80
6x28x34	6x28x34	6x36x42	6x36x42	52x44x18	58x50x18	62x54x20	62x54x20

* = Customized bores, key-ways and inner square dimensions possible
 Md_{max} = Max. permissible torque (when using material 1.4057 divide the Md_{max}-value in halves)
 β = Max. angle of deflection per joint
 S₁
 S₂ = preferred lengths, compressed
 S₃
 X₁ = Maximum extension for S₁
 X₂ = Maximum extension for S₂
 X₃ = Maximum extension for S₃
 For application criteria and calculations refer to technical annex

with length compensation, Bore with key-way DIN 6885, Sheet 1

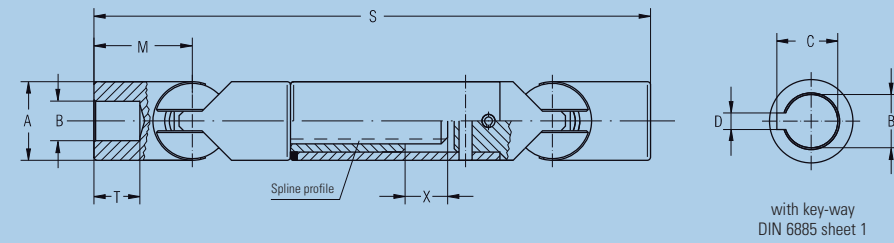
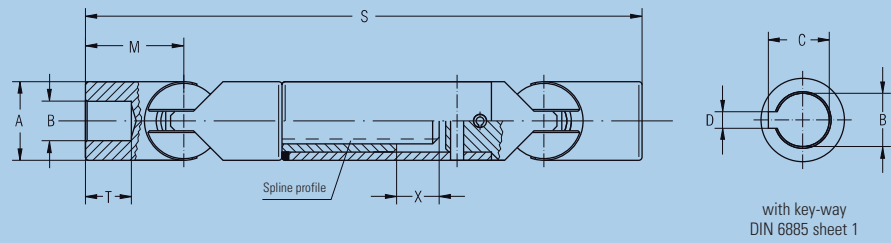

When ordering, please indicate compressed length and extension!

Ball and Socket Shafts, Bore with key-way DIN 6885, Sheet 1

Order number		0.820.103	0.824.103	0.828.103	0.832.103	0.836.103	0.840.103	0.845.103
Md _{max}	Nm	20	30	50	60	120	160	200
Angle of deflection β	°	35	35	35	35	35	35	35
Weight by S ₁	kg	0,32	0,50	0,78	1,10	1,58	2,17	2,92
Weight by S ₂	kg	0,36	0,58	0,85	1,22	1,72	2,28	3,38
Weight by S ₃	kg	0,40	0,62	0,98	1,33	1,82	2,52	3,68
A	mm	20	24	28	32	36	40	45
*B ^{H7}	mm	10	12	14	16	18	20	22
*C ^{+0.2}	mm	11,4	13,8	16,3	18,3	20,8	22,8	24,8
*D ^{P9}	mm	3	4	5	5	6	6	6
*F ^{H9}	mm	–	–	–	–	–	–	–
M	mm	25	30	35	40	45	50	55
S ₁ + X ₁	mm	150 + 20	170 + 25	200 + 30	220 + 30	250 + 35	280 + 40	300 + 40
S ₂ + X ₂	mm	170 + 40	200 + 55	220 + 50	250 + 60	280 + 65	300 + 60	350 + 90
S ₃ + X ₃	mm	200 + 70	220 + 75	250 + 80	280 + 90	300 + 85	350 + 110	400 + 140
T	mm	13	14	17	19	22	24	26
Spline profile	mm	6x11x14	6x11x14	6x16x20	6x16x20	6x18x22	6x21x25	6x21x25

	0.850.103	0.855.103	0.860.103	0.865.103	0.870.103	0.880.103	0.890.103	0.896.103
	290	440	520	700	820	930	1060	1250
	35	35	35	35	35	35	35	35
	4,27	5,50	7,78	10,4	13,6	20,1	27,7	35,8
	4,58	5,98	8,45	10,8	14,7	21,9	30,6	38,7
	5,18	6,62	9,58	11,8	16,2	24,5	33,5	41,7
	50	55	60	65	70	80	90	100
	25	30	35	40	45	50	60	70
	28,3	33,3	38,3	43,3	48,8	53,8	64,4	74,9
	8	8	10	12	14	14	18	20
	–	–	–	–	–	–	–	–
	62,5	67,5	82,5	95	105	115	130	145
	350 + 50	400 + 50	450 + 50	520 + 70	580 + 70	630 + 70	700 + 70	800 + 100
	400 + 100	450 + 100	500 + 100	550 + 100	630 + 120	700 + 140	800 + 170	900 + 200
	450 + 150	500 + 160	580 + 180	630 + 180	700 + 190	800 + 240	900 + 270	1000 + 300
	30	35	42	46	52	58	70	80
	6x28x34	6x28x34	6x36x42	6x36x42	52x44x18	58x50x18	62x54x20	62x54x20

* = Customized bores, key-ways and inner square dimensions possible
 Md_{max} = Max. permissible torque (when using material 1.4057 divide the Md_{max}-value in halves)
 β = Max. angle of deflection per joint
 S₁
 S₂ = preferred lengths, compressed
 S₃
 X₁ = Maximum extension for S₁
 X₂ = Maximum extension for S₂
 X₃ = Maximum extension for S₃
 For application criteria and calculations refer to technical annex

with length compensation, Inner square

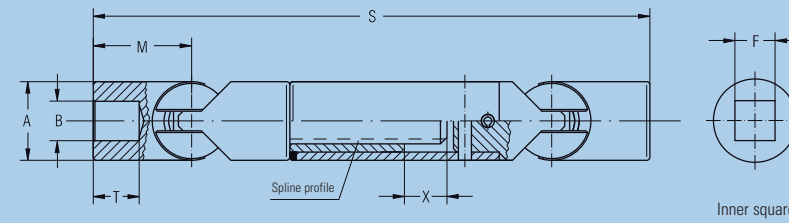
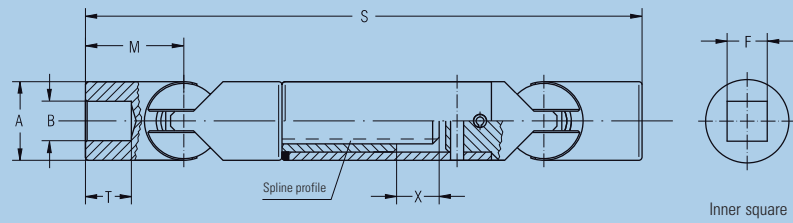

When ordering, please indicate compressed length and extension!

Ball and Socket Shafts, Inner square

Order number		0.820.104	0.824.104	0.828.104	0.832.104	0.836.104	0.840.104	0.845.104
Md _{max}	Nm	20	30	50	60	120	160	200
Angle of deflection β	°	35	35	35	35	35	35	35
Weight by S ₁	kg	0,32	0,50	0,78	1,10	1,58	2,17	2,92
Weight by S ₂	kg	0,36	0,58	0,85	1,22	1,72	2,28	3,38
Weight by S ₃	kg	0,40	0,62	0,98	1,33	1,82	2,52	3,68
A	mm	20	24	28	32	36	40	45
*B ^{H7}	mm	–	–	–	–	–	–	–
*C ^{+0.2}	mm	–	–	–	–	–	–	–
*D ^{P9}	mm	–	–	–	–	–	–	–
*F ^{H9}	mm	10	12	14	16	18	20	22
M	mm	25	30	35	40	45	50	55
S ₁ + X ₁	mm	150 + 20	170 + 25	200 + 30	220 + 30	250 + 35	280 + 40	300 + 40
S ₂ + X ₂	mm	170 + 40	200 + 55	220 + 50	250 + 60	280 + 65	300 + 60	350 + 90
S ₃ + X ₃	mm	200 + 70	220 + 75	250 + 80	280 + 90	300 + 85	350 + 110	400 + 140
T	mm	13	14	17	19	22	24	26
Spline profile	mm	6x11x14	6x11x14	6x16x20	6x16x20	6x18x22	6x21x25	6x21x25

	0.850.104	0.855.104	0.860.104	0.865.104	0.870.104	0.880.104	0.890.104	0.896.104
	290	440	520	700	820	930	1060	1250
	35	35	35	35	35	35	35	35
	4,27	5,50	7,78	10,4	13,6	20,1	27,7	35,8
	4,58	5,98	8,45	10,8	14,7	21,9	30,6	38,7
	5,18	6,62	9,58	11,8	16,2	24,5	33,5	41,7
	50	55	60	65	70	80	90	100
	–	–	–	–	–	–	–	–
	–	–	–	–	–	–	–	–
	–	–	–	–	–	–	–	–
	25	30	32	36	40	42	50	54
	62,5	67,5	82,5	95	105	115	130	145
	350 + 50	400 + 50	450 + 50	520 + 70	580 + 70	630 + 70	700 + 70	800 + 100
	400 + 100	450 + 100	500 + 100	550 + 100	630 + 120	700 + 140	800 + 170	900 + 200
	450 + 150	500 + 160	580 + 180	630 + 180	700 + 190	800 + 240	900 + 270	1000 + 300
	30	35	42	46	52	58	70	80
	6x28x34	6x28x34	6x36x42	6x36x42	52x44x18	58x50x18	62x54x20	62x54x20

* = Customized bores, key-ways and inner square dimensions possible
 Md_{max} = Max. permissible torque (when using material 1.4057 divide the Md_{max}-value in halves)
 β = Max. angle of deflection per joint
 S₁
 S₂ = preferred lengths, compressed
 S₃
 X₁ = Maximum extension for S₁
 X₂ = Maximum extension for S₂
 X₃ = Maximum extension for S₃
 For application criteria and calculations refer to technical annex

0.800

0.800

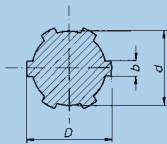
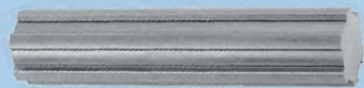

Spline Shafts DIN ISO 14

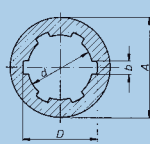

Spline Bore Hubs DIN ISO 14

Material: C40 k, 1.0511 oder C45 k, 1.0503
Material: 35 S 20 k, 1.0726

Material: 11SMnPb 30 k, 1.0718

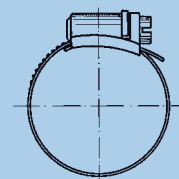

Material: steel, zinc-plated or stainless steel, corrosion- and acid-resistant

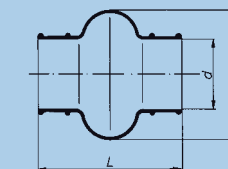

Material: neoprene; temperature-resistant up to 100 °C

Also available with Spigots

Spline Shafts DIN ISO 14

Order number	1.000.524.001	1.000.524.002	1.000.524.003	1.000.524.004	1.000.524.005	1.000.524.007	1.000.524.006
Designation	B 6 x 11 x 14	B 6 x 16 x 20	B 6 x 18 x 22	B 6 x 21 x 25	B 6 x 28 x 32	B 6 x 28 x 34	B 6 x 36 x 42
D mm	14	20	22	25	32	34	42
d mm	11	16	18	21	28	28	36
b mm	3	4	5	5	7	7	8
Available in all lengths up to mm	3000	3000	3000	3000	500*	3000	500*

Material: C40 k, 1.0511 oder C45 k, 1.0503
* = Material: 35 S 20 k, 1.0726

Spline Bore Hubs DIN ISO 14

Order number	1.000.511.001	1.000.511.002	1.000.511.003	1.000.511.004	1.000.511.005	1.000.511.007	1.000.511.006
Designation	A 6 x 11 x 14	A 6 x 16 x 20	A 6 x 18 x 22	A 6 x 21 x 25	A 6 x 28 x 32	A 6 x 28 x 34	A 6 x 36 x 42
D mm	14	20	22	25	32	34	42
d mm	11	16	18	21	28	28	36
b mm	3	4	5	5	7	7	8
A mm	20	28	36	40	50	50	60
Length* mm	50	60	70	70	80	60	100

* = max. grip length even
Material: 11SMnPb 30 k, 1.0718

Hose Clips, steel, zinc-plated

Order number	1.000.961.011	1.000.961.029	1.000.961.003	1.000.961.006	1.000.961.012	1.000.961.013	1.000.961.014	1.000.961.010
Joint-size	0.716/0.816/ 0.720/0.820	0.824/0.725/ 0.828	0.732/0.832/ 0.836	0.740/0.840/ 0.845	0.750/0.850/ 0.855	0.860/0.865	0.870	0.880
Clamping range mm	12 – 20	20 – 32	25 – 40	32 – 50	40 – 60	50 – 70	60 – 80	70 – 90

Hose Clips, stainless steel, corrosion- and acid-resistant

Order number	1.000.961.020	1.000.961.022	1.000.961.023	1.000.961.024	1.000.961.025	1.000.961.026	1.000.961.027	1.000.961.028
Joint-size	0.716/0.816/ 0.720/0.820	0.824/0.725/ 0.828	0.732/0.832/ 0.836	0.740/0.840/ 0.845	0.750/0.850/ 0.855	0.860/0.865	0.870	0.880
Clamping range mm	12 – 20	20 – 32	25 – 40	32 – 50	40 – 60	50 – 70	60 – 80	70 – 90

Bellows

Order number	1.000.830.009	1.000.830.010	1.000.830.013	1.000.830.014	1.000.830.002	1.000.830.003
Joint-size	0.716/0.816	0.720/0.820	0.725/0.824	0.828	0.732/0.832	0.836
L mm	40	47	52	58	67	74
D mm	31	33	46	50	54	65
d mm	16	20	25	28	32	36

1.000.830.004	1.000.830.015	1.000.830.016	1.000.830.006	1.000.830.007	1.000.830.017
0.740/0.840	0.845	0.750/0.850	0.855/0.860	0.865/0.870	0.880
84	97	110	122	132	157
75	82	90	100	110	131
040	45	50	56	65	80