

At utilisation of the nominal torque a verification of the flange connection is necessary.

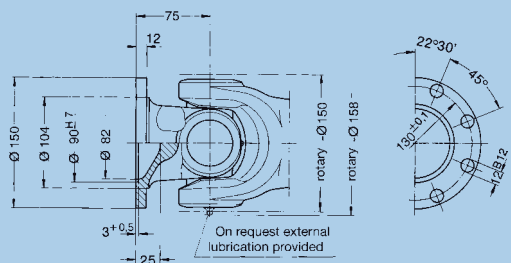

Standard flange  
end number: 0.158.XX0

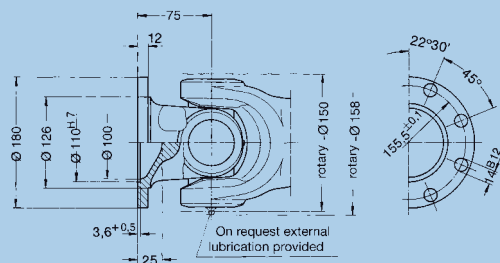

Larger flange  
end number: 0.158.XX1

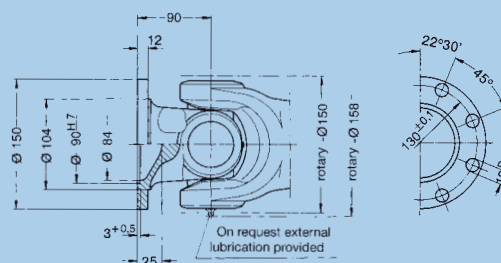

Flange for larger deflection  
end number: 0.158.XX5

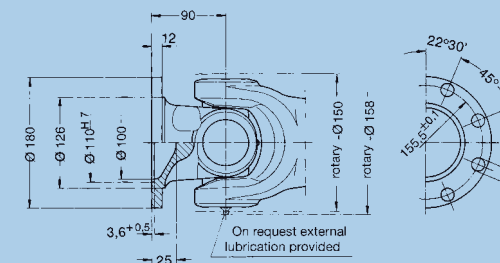

Larger flange for larger deflection  
end number: 0.158.XX6

Cross Units, Roller bearing version

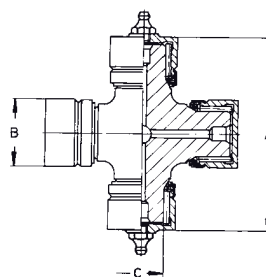
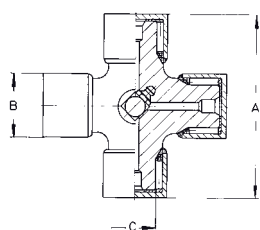

	Standard version Roller bearing	Version suitable for external lubrication Roller bearing
<b>Order number</b>	<b>0.158.015</b>	<b>0.158.016</b>
A	mm 126	mm 126
B	mm 48	mm 48
C	mm 33,15	mm 33,15
Snap rings included	mm J 48 x 1,75	mm J 48 x 1,75
Weight	kg 2,28	kg 2,29

β\* = Maximum angle of deflection per joint  
X = Preferred extension (larger extension available up to approx. 9 x spline o. D.)

Fixed joint

Slip joint (sliding sleeve type)

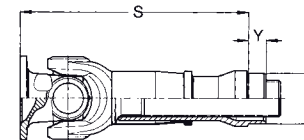
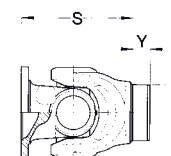

Please indicate compressed length „S“, extension and required type of flange when ordering!

	Roller bearing version							
	without extension				larger extension			
<b>Order number</b>	<b>0.158.050</b>	<b>0.158.051</b>	<b>0.158.055</b>	<b>0.158.056</b>	<b>0.158.070</b>	<b>0.158.071</b>	<b>0.158.075</b>	<b>0.158.076</b>
Angle of deflection β*	20	20	35	35	20	20	35	35
Weight	10,12	10,90	10,55	11,36	20,78	21,56	21,21	22,02
Flange-Ø	150	180	150	180	150	180	150	180
S	185	185	200	200	475	475	490	490
X	-	-	-	-	110	110	110	110
Y	22	22	22	22	25	25	25	25
Z	82,25	82,25	82,25	82,25	82,25	82,25	82,25	82,25
Spline dim. DIN 5480	-	-	-	-	60x2,5x22	60x2,5x22	60x2,5x22	60x2,5x22
Number of flange holes	8	8	8	8	8	8	8	8

\* Please refer to point 6.7 of the technical attachment.

The dimensions Z, Y and S will be changed within a product change. Please contact us for further questions.