

At utilisation of the nominal torque a verification of the flange connection is necessary.

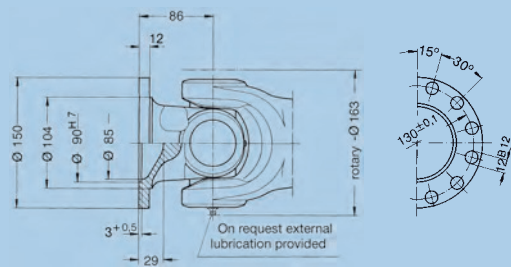

On both sides standard flange end number: 0.117.XX0

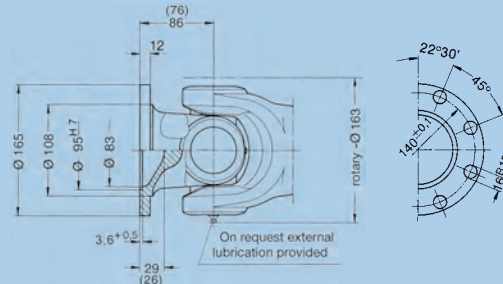

On both sides larger flange (Ø 165 mm) end number: 0.117.XX1
Dimensions in brackets are only valid for short type I

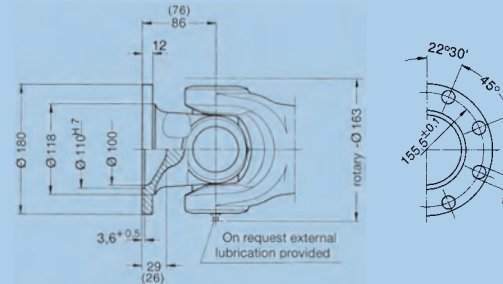

On both sides larger flange (Ø 180 mm) end number: 0.117.XX1
Dimensions in brackets are only valid for short type I

Cross Units, Roller bearing version

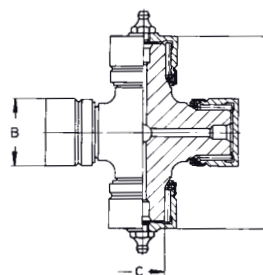
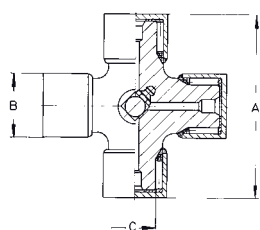

	Standard version Roller bearing	Version suitable for external lubrication Roller bearing
Order number	0.117.015	0.117.016
A	mm 135	mm 135
B	mm 53	mm 53
C	mm 37,34	mm 37,34
Snap rings included	mm J 53 x 2	mm J 53 x 2
Weight	kg 3,26	kg 3,28

β* = Maximum angle of deflection per joint
X = Preferred extension (larger extension available up to approx. 9 x spline o. D.)

Fixed joint

Slip joint (sliding sleeve type)

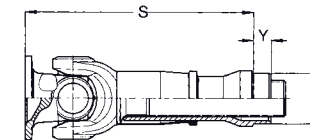
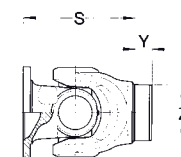

Please indicate compressed length „S“, extension and required type of flange when ordering!

	Roller bearing version							
	without extension				larger extension			
Order number	0.117.050	0.117.051	0.117.051	–	0.117.070	0.117.071	0.117.071	–
Angle of deflection β*	30	30	30	–	30	30	30	–
Weight	12,29	12,52	13,06	–	21,99	22,13	22,75	–
Flange-Ø	150	165	180	–	150	165	180	–
S	184	184	184	–	412/(457)	412/(457)	412/(457)	–
X	–	–	–	–	110	110	110	–
Y	28	28	28	–	30	30	30	–
Z	90,25	90,25	90,25	–	90,25	90,25	90,25	–
Spline dim. DIN 5480	–	–	–	–	65x2,5x24	65x2,5x24	65x2,5x24	–
Number of flange holes	12	8	8	–	12	8	8	–

* Please refer to point 6.7 of the technical attachment.

The dimensions Z, Y and S will be changed within a product change. Please contact us for further questions.