

At utilisation of the nominal torque a verification of the flange connection is necessary.

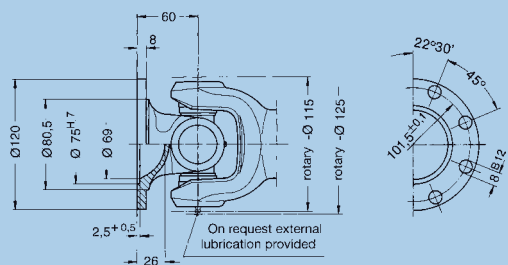

Standard flange
end number: 0.112.XX0

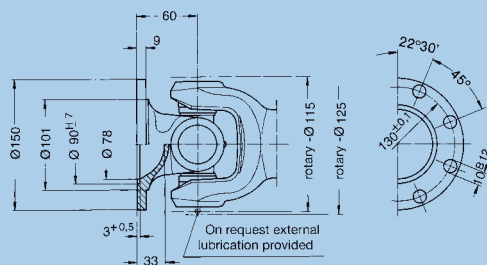

Larger flange
end number: 0.112.XX1

One keyway is not enough to transmit the max. torque. In such case a second keyway or an internal spline is recommended.

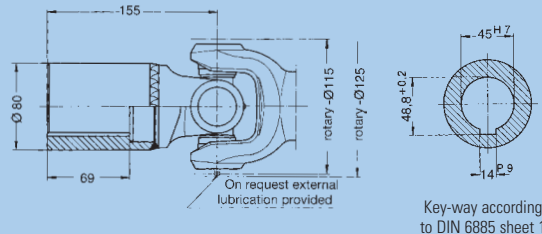

Connecting hub
without key-way end number: 0.112.XX2
with key-way end number: 0.112.XX3

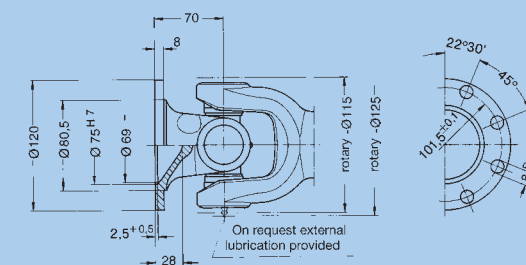

Flange for larger angle of deflection
end number: 0.112.XX5

Cross Units

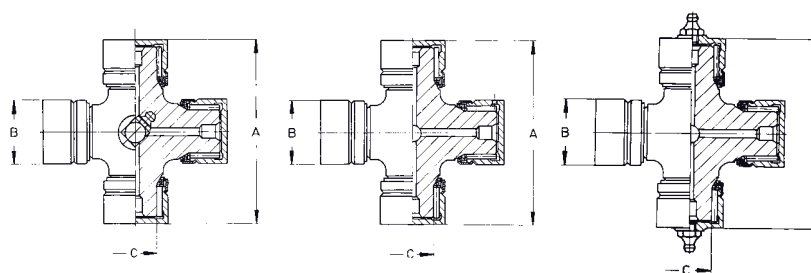

	Needle bearing version		
	Standard version Needle bearing	Lubrication for version 0.100.3XX Needle bearing	Version suitable for external lubrication Needle bearing
Order number	0.112.010	0.112.011	0.112.012
A	mm 97	97	97
B	mm 35	35	35
C	mm 23,04	23,04	23,04
Snap rings included	mm J 35 x 1,5	J 35 x 1,5	J 35 x 1,5
Weight	kg 1,03	1,02	1,03

	Roller bearing version		
	Standard version Roller bearing	Lubrication for version 0.100.3XX Roller bearing	Version suitable for external lubrication Roller bearing
Order number	0.112.015	0.112.017	0.112.016
A	mm 97	97	97
B	mm 35	35	35
C	mm 24,8	24,8	24,8
Snap rings included	mm J 35 x 1,5	J 35 x 1,5	J 35 x 1,5
Weight	kg 1,06	1,05	1,06

β* = Maximum angle of deflection per joint
X = Preferred extension (larger extension available up to approx. 9 x spline o. D.)

Fixed joint Slip joint Slip joint (sliding sleeve type)

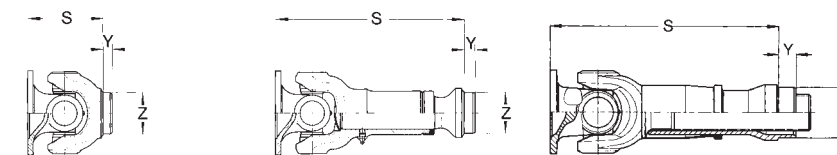

Please indicate compressed length „S“, extension and required type of flange when ordering!

	Needle resp. Roller bearing version											
	without extension				standard extension				larger extension			
Order number	0.112.050	0.112.051	0.112.052	0.112.055	0.112.060	0.112.061	0.112.062	0.112.065	0.112.070	0.112.071	0.112.072	0.112.075
Angle of deflection β*	20	18	20	35	20	18	20	35	20	18	20	35
Weight	kg 3,80	4,48	6,09	3,93	6,63	7,31	8,92	6,73	7,26	7,94	9,55	7,94
Flange-Ø	mm 120	150	Nabe	120	120	150	Nabe	120	120	150	Nabe	120
S	mm 135	135	220	145	306	306	401	330	318	318	413	335
X	mm -	-	-	-	60	60	60	60	120	120	120	120
Y	mm 10	10	10	10	10	10	10	10	10	10	10	10
Z	mm 51,85	51,85	51,85	51,85	51,85	51,85	51,85	51,85	51,85	51,85	51,85	51,85
Spline dim. DIN 5480	mm -	-	-	-	42x2x20	42x2x20	42x2x20	42x2x20	42x2x20	42x2x20	42x2x20	42x2x20
Number of flange holes	8	8	-	8	8	8	-	8	8	8	-	8

* Please refer to point 6.7 of the technical attachment.

The dimensions Z, Y and S will be changed within a product change. Please contact us for further questions.