

At utilisation of the nominal torque a verification of the flange connection is necessary.

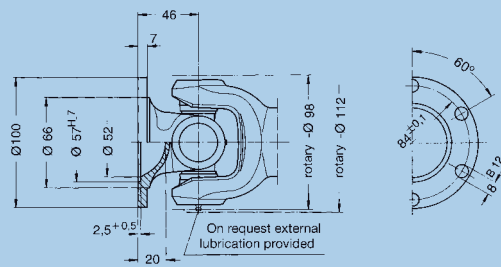

Standard flange
end number: 0.110.XX0

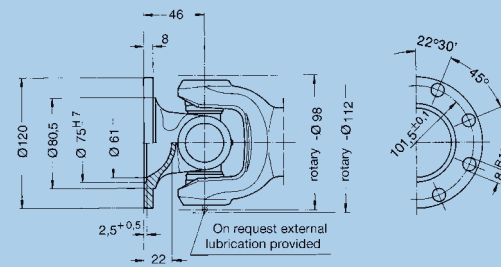

Larger flange
end number: 0.110.XX1

One keyway is not enough to transmit the max. torque. In such case a second keyway or an internal spline is recommended.

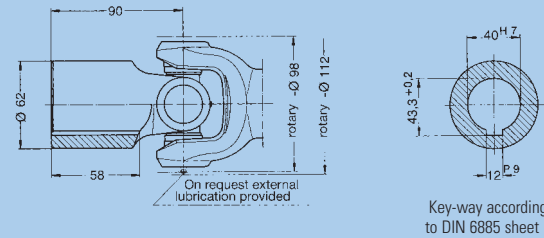

Connecting hub
without key-way end number: 0.110.XX2
with key-way end number: 0.110.XX3

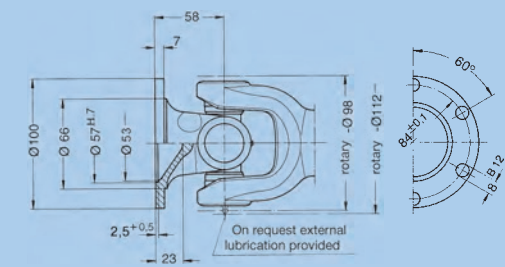

Flange for larger deflection
end number: 0.110.XX5

Cross Units, Roller bearing version

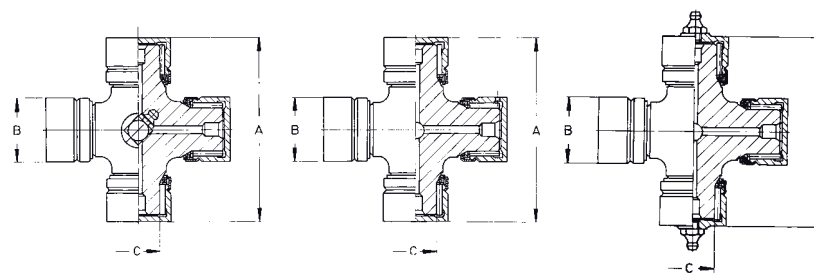

	Standard version Roller bearing	Lubrication for version 0.100.3XX Roller bearing	Version suitable for external lubrication Roller bearing
Order number	0.110.015	0.110.017	0.110.016
A	mm 83	83	83
B	mm 30	30	30
C	mm 20,02	20,02	20,02
Snap rings included	mm J 30 x 1,2	J 30 x 1,2	J 30 x 1,2
Weight	kg 0,66	0,65	0,66

β* = Maximum angle of deflection per joint
X = Preferred extension (larger extension available up to approx. 9 x spline o. D.)

Fixed joint

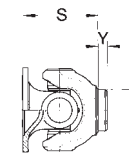

Slip joint

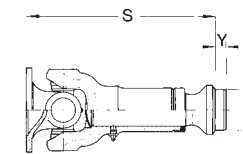

Slip joint (sliding sleeve type)

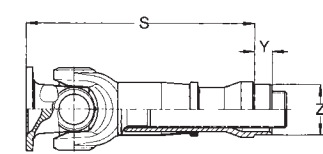

Please indicate compressed length „S“, extension and required type of flange when ordering!

	Roller bearing version											
	without extension				standard extension				larger extension			
Order number	0.110.050	0.110.051	0.110.052	0.110.055	0.110.060	0.110.061	0.110.062	0.110.065	0.110.070	0.110.071	0.110.072	0.110.075
Angle of deflection β*	20	18	20	35	20	18	20	35	20	18	20	35
Weight	2,38	2,60	2,75	2,45	3,83	4,06	4,20	4,01	4,70	4,92	5,07	4,77
Flange-Ø	100	120	Hub	100	100	120	Hub	100	100	120	Hub	100
S	105	105	149	117	237	237	281	256	244	244	288	256
X	-	-	-	-	40	40	40	40	95	95	95	95
Y	15	15	15	15	15	15	15	15	18	18	18	18
Z	44,25	44,25	44,25	44,25	44,25	44,25	44,25	44,25	44,25	44,25	44,25	44,25
Spline dim. DIN 5480	-	-	-	-	35x2x16	35x2x16	35x2x16	35x2x16	35x2x16	35x2x16	35x2x16	35x2x16
Number of flange holes	6	8	-	6	6	8	-	6	6	8	-	6

* Please refer to point 6.7 of the technical attachment.

The dimensions Z, Y and S will be changed within a product change. Please contact us for further questions.